

**FINN****HydroSeeder®****Series II****Model T120**

*T120 Series II HydroSeeder  
Gooseneck Trailer. (T120GN)*

The FINN T120 Series II HydroSeeder is a real workhorse with a 1,000 gallon working tank capacity. FINN developed HydroSeeder technology in 1953. We've been the industry leader in quality and innovation ever since. With the FINN T120 Series II, you don't have to settle for less than proven FINN quality to tackle a wide range of highly demanding hydroseeding applications.

### **Power To Spare.**

The T120 Series II provides muscle with a rugged and dependable 33.5 hp, 4 cylinder water cooled Kubota diesel engine. Available in skid, gooseneck trailer, or straight pull trailer configurations, the T120 Series II HydroSeeder covers up to 1/3 of an acre with one full tank. Tower discharge distance reaches up to 180 feet for greater slurry application and efficient coverage. In addition, the T120 Series II is equipped with full deck railing and plenty of storage capacity to carry extra materials.

### **Positive Control.**

The FINN T120 Series II HydroSeeder features a heavy-duty agitator driven by a variable speed, reversible hydraulic motor. The agitator and pump are independently driven, allowing for complete mixing of the slurry without pump operation, and FINN's direct drive clutch and pump assembly are specifically designed to optimize horsepower efficiency and maximize pump performance.

*Models shown include optional equipment.*

Other features include independent rubber torsion suspension axles that are equipped with electric brakes, including break-away switch; and a direct drive clutch with an adjustable external wear plate.

As the world leader for over 70 years in the design and manufacture of innovative, quality equipment for the green industry, and as the inventor of the HydroSeeder, FINN Corporation is committed to your complete satisfaction.



*T120 Series II HydroSeeder Straight Pull Trailer. (T120T)*



*T120 Series II HydroSeeder Skid Mounted. (T120S)*



# HydroSeeder®

## Series II

## Model T120 with Tier 4F Engine

### T120GN GOOSENECK TRAILER

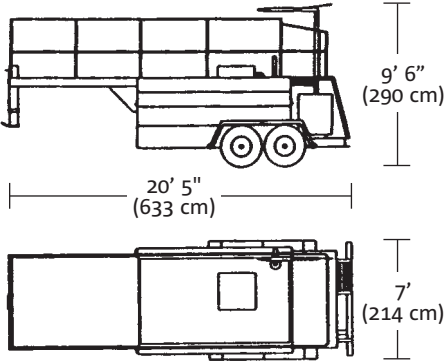

### T120T STRAIGHT PULL TRAILER

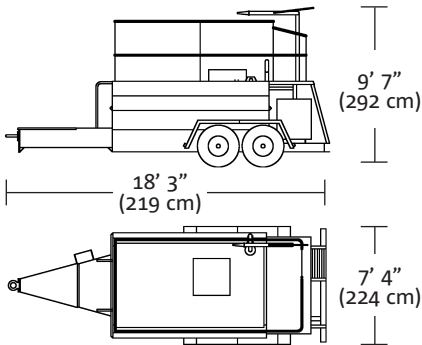

### T120S SKID MOUNT

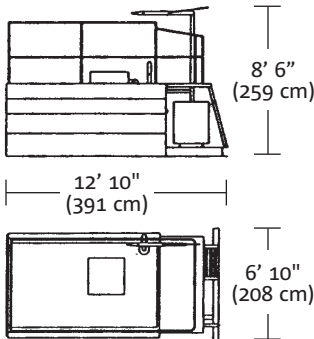

### FINN MODEL T120 TECHNICAL SPECIFICATIONS

POWER.....	Yanmar 3TNV88C-DYEM, 35.1hp (26.2kw), 3 cylinder water cooled diesel engine with over-center clutch. Tier 4Final. 1.642L
ENGINE SAFETY SYSTEM.....	Low oil pressure, high water temperature shutoff
TANK SIZE.....	1,180 gallon (4,468 liter) liquid capacity, 1,000 gallon (3,785 liter) working capacity
LOADS PER ACRE <sup>1</sup> .....	3
FUEL TANK CAPACITY.....	13.5 gallon (51.1 liter)
PUMP.....	Centrifugal 4" x 2" (10 cm x 5 cm) 170 gpm @ 100 psi, (646 lpm @ 7 kg/cm <sup>2</sup> ), 3/4" (1.9 cm) solid clearance, external adjustment
PUMP DRIVE.....	Direct drive with over center clutch, pump drive is independent of agitator operation
AGITATION.....	Mechanical paddle agitation and liquid recirculation
AGITATOR DRIVE.....	Reversible, variable speed hydraulic motor drive (0-95 rpm)
DISCHARGE DISTANCE.....	Up to 180 feet (55 m) from end of discharge tower
MAX. MATERIAL CAPACITY.....	3,200 lbs. (1,450 kg) granular solids, 500 lbs. (225 kg) fiber mulch
NOZZLES.....	(1) narrow fan, (1) wide fan, (2) long distance
EMPTY WEIGHT <sup>2</sup> .....	T120GN 6,620 lbs. (3,003 kg) T120T 5,730 lbs. (2,599 kg) T120S 4,680 lbs. (2,123 kg)
WORKING WEIGHT <sup>2</sup> .....	T120GN 18,000 lbs. (8,165 kg) T120T 17,400 lbs. (7,893 kg) T120S 16,280 lbs. (7,384 kg)
BRAKES.....	Electric on both axles with break-away switch
LIGHTS.....	D.O.T. including marker, identification lights and license plate bracket
TIRES.....	ST235/85R16 radial, load range E
TRAILER AXLES.....	T120 Tandem 7,200 lbs. (3,266 kg) rubber torsion
HITCH WEIGHT.....	T120GN 3,500 lbs. (1,588 kg) T120T 2,800 lbs. (1,270 kg)

<sup>1</sup>Loads per acre based on an application rate of 1500 lbs. mulch/acre.

<sup>2</sup>Weights are preliminary. Working weights are approximate and do not include stored materials.

FINN Corporation has a policy of continuous product improvement, and reserves the right to change design and specifications without notice.

HydroSeeder® and the FINN Design® Logo are registered trademarks of FINN Corporation.

