

# SCREEN MACHINE™ 107T SCALPER SCREEN PLANT

AMERICAN-MADE INNOVATION SINCE 1966



## SUPERIOR SCALPING!

- Patented Dual-Screen Design
- Patented Smooth Start® Technology
- Tracked, Remote Control Operation

### 107T SPECIFICATIONS

Height	11'-0"	3.35m
Length	38'-0"	11.58m
Width	8'-5"	2.57m
Total Weight	44,980 lbs.	20,403Kg

Patented dual screen design with center support (U.S. Patent #6,000,553) provides extended machine and screen performance

Smooth Start® Technology (U.S. Patent #6,669,026) eliminates stress and shaking at start-up and shut-down

Hydraulically adjustable screen angles

Key structural components manufactured from U.S.-made grade 80 steel

Conveyor discharge height of 11'-0" (3.35m)

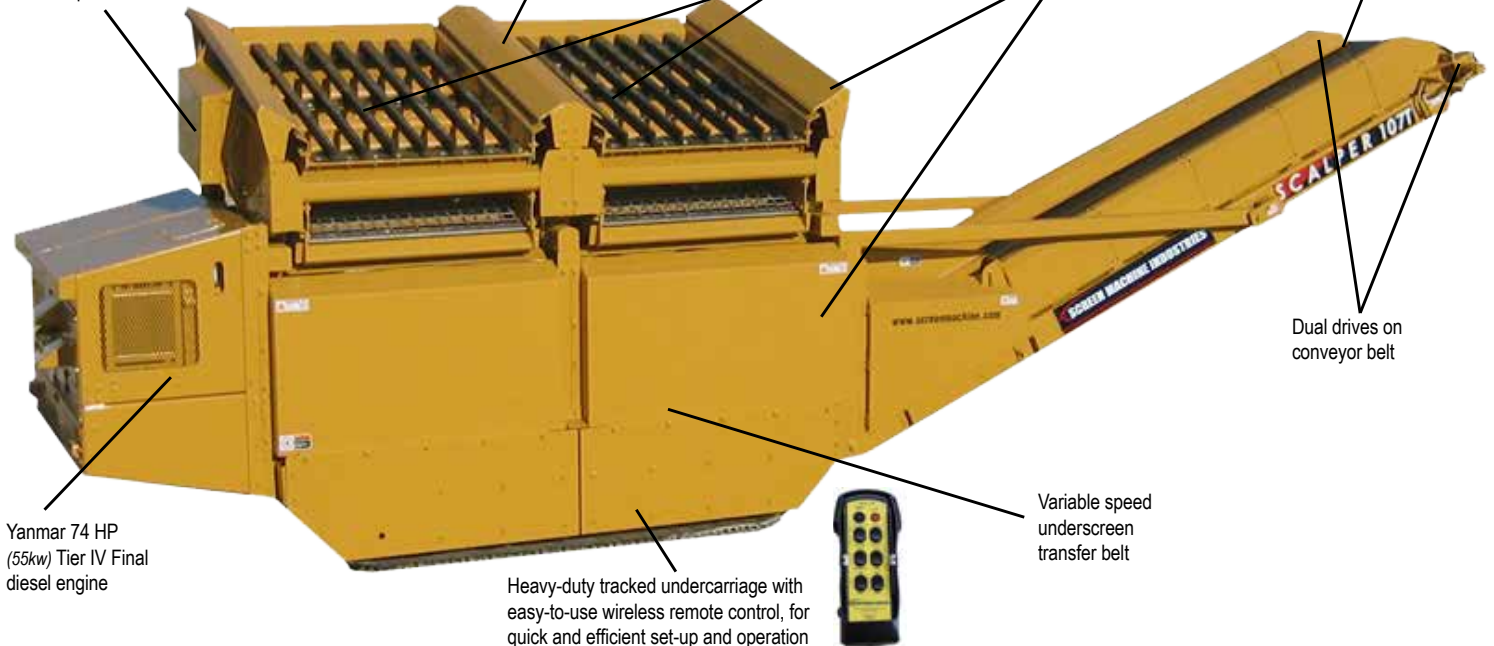

Yanmar 74 HP (55kw) Tier IV Final diesel engine

Heavy-duty tracked undercarriage with easy-to-use wireless remote control, for quick and efficient set-up and operation



Variable speed underscreen transfer belt

Dual drives on conveyor belt

## OPERATING DIMENSIONS

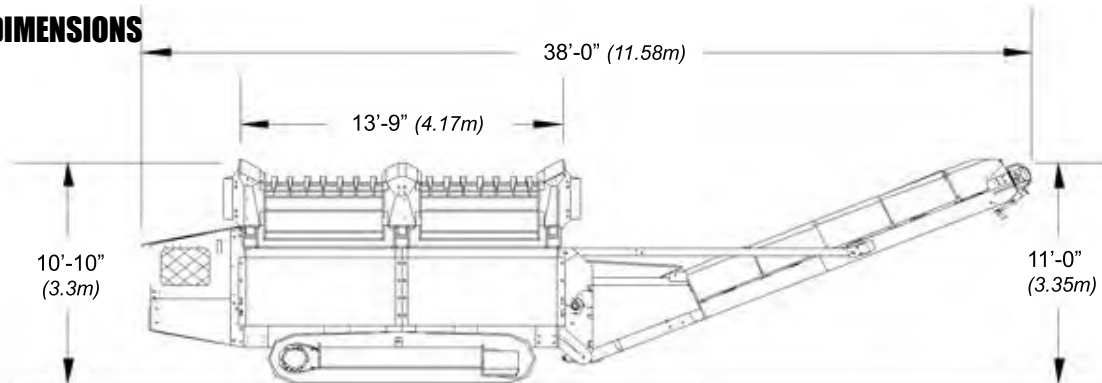

## TRANSPORT DIMENSIONS

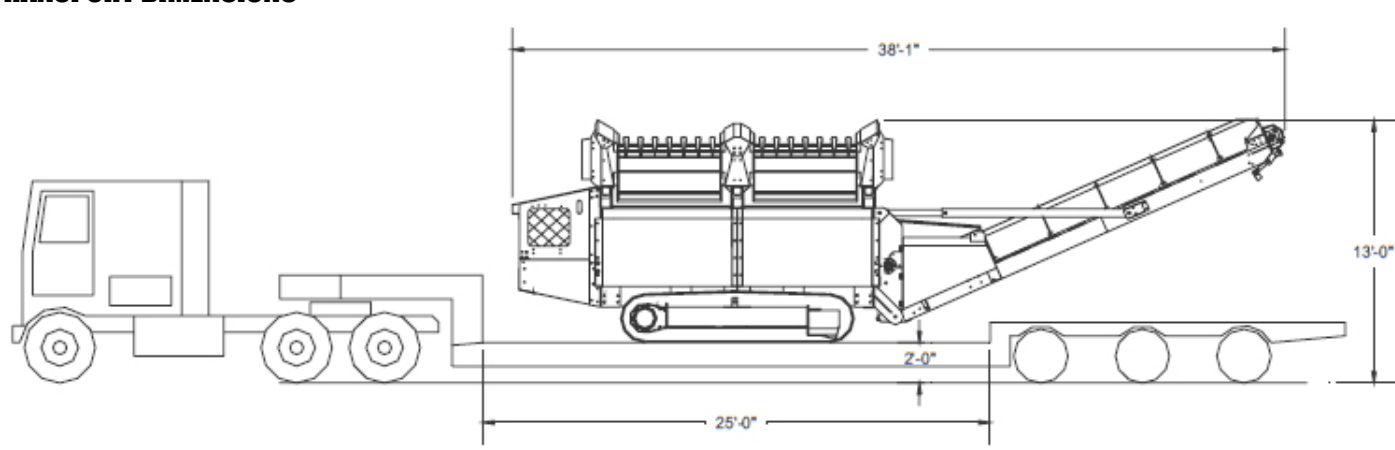

## SCREEN

- Dual 5'-0" x 7'-0" (1.52m x 2.13m) two-bearing screens
- Adjustable screen angles (5°, 10°, 15°)
- 3/8" (9.52 mm) grade 80 steel bolt together construction
- Smooth Start® Technology (patent #6,669,026)
- 13'-9" (4.19m) feed width and 10'-10" (3.30m) feed height
- Feed width goes to 17' (5.18m) with optional wing plate extensions
- 8" (20 cm) clearance between decks

## POWER SYSTEMS and STRUCTURE

- Yanmar® 74 HP (55kw) Tier IV Final diesel engine
- 125 gallon (473L) baffled hydraulic tank and oil cooler
- 50 gallon (189L) fuel tank
- Lockable control panels
- Four (4) emergency stops
- One (1) shutdown on remote control
- Conveyors stop when in move mode
- Hydraulic conversation kit to power TH60 60'x36" conveyor

## CONVEYOR/BELTS

- Guide rollers to optimize belt alignment
- Variable speed feeder with 42" (1,067m) belt width
- Full deep trough skirting
- Dual hydraulic drive on main conveyor
- 5" (127mm) diameter "C" idlers
- Lagged head pulley
- Wing type tail pulley
- Rubber disc return idlers

## STRUCTURE/UNDERCARRIAGE

- Heavy-duty center frame support structure
- USA-made grade 80 steel construction
- Heavy-duty tracked undercarriage
- Wireless remote control operation and travel

## LOADING OPERATION

- 3-5 Cu. Yard loader (2.29- 3.82 Cu. Meter)



Height	Length	Width	Weight	Screen Size (2)	Conveyor Width	Discharge Height	Engine	Tracks	Fuel Capacity	Hydraulic Capacity
11'-0"	38'-0"	8'-5"	44,980lbs	5'-0"x7'-0"	42"	11'-0"	Yanmar	20" wide	50gal	120gal
3.35m	11.58m	2.57m	20,403kgs	1.52m x2 1.3m	1,067mm	3.35m	74 HP 55kw	500mm	189L	473L